

SAV-SL Series Knife Gate Valve



A division of Skinner AgSolutions, Inc.

www.SAValves.us

SLURRY KNIFE GATE VALVE

The SAV SL model knife gate is a bi-directional wafer valve equipped with two metal reinforced rubber sleeves, designed for applications with abrasive slurries. The SAV-SL slurry knife gate valve is mainly used in industries such as:

- Mining
- Chemical plants
- Etc.
- Power plants
- Wastewater treatment

Sizes:

DN 2"/50mm to 36"/DN 900mm (larger DN on request)

Working pressure:

DN 2"/ 50mm to 16"/400mm 150 psi/(10 kg/cm²)
 DN 18"/450mm to 24"/600mm 90 psi/(6 kg/cm²) or 150psi/(10 kg/cm²)
 DN 28"/700mm to 36"/900mm 75 psi/(5 kg/cm²) or 150psi/(10 kg/cm²)
 Higher pressures and/or diameters on request

Standard Flange connection:

DIN PN 10 and ANSI B16.5 (class 150)

Other: (On request)

DIN PN 6

DIN PN 16

DIN PN 25

BS "D" and "E"

ANSI 125

Others on request

Directives:

2006/42/CE (MACHINES)

2014/68/EU (PED) Fluid: Group 1(b), 2 (Cat. I, mod. A)

2014/34/EU (ATEX)

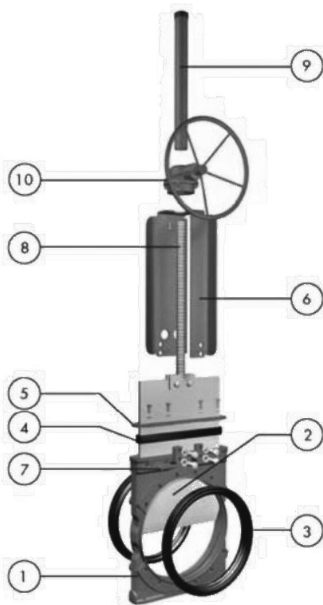
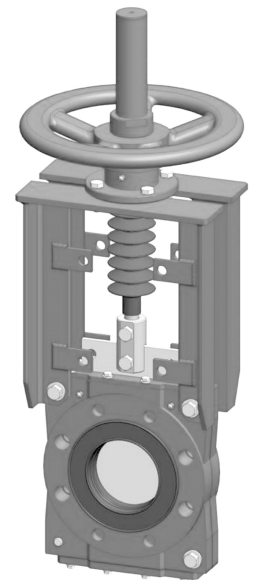

STANDARD PARTS LIST

Part:

Materials:

Part:	Materials:
1- Body	Ductile iron A536 (60-40-18) / 0.7040 / GJS 400
2- Gate	AISI 304 (1.4301) / AISI 316 (1.4401)
3- Sleeves	Natural rubber / EPDM
4- Packing	EPDM
5- Gland Follower	A570 GR.40 / 1.0044 Epoxy coated
6- Yoke	A570 GR.40 / 1.0044 Epoxy coated
7- Grease Nipple	Zinc coated carbon-steel
8- Stem	AISI 430 / 1.4016
9- Stem protector	A570 GR.40 / 1.0044 Epoxy coated
10- Bevel Gear	/